

FACILITIES GUIDE & SPORTS DIRECTORY

www.gwinnettsportscommission.org



> Table of Contents



- 1 Contact Information**
- 2 About Us**
- 4 Facilities**
 - 4 Arena at Gwinnett Center
 - 6 Gwinnett Center
 - 8 Suwanee Sports Academy
 - 9 Road Atlanta
 - 10 Racquet Club of the South,
Collins Hill Athletic Club
 - 11 Park Locations
 - 12 Atlanta Ice Forum,
South Gwinnett Park/
SGAA Dual Deck Arena
 - 13 Gary Pirkle Park
- 14 Housing Services**
- 18 Local Transportation**
- 19 Attractions**
- 21 Request for Proposal**
- 24 Baseball / Softball**
- 25 Basketball / Bowling**
- 26 Multi-Purpose Facilities**
Cheerleading, Gymnastics, Table Tennis,
Martial Arts, Weightlifting, Wrestling
- 27 Equestrian**
- 28 On Ice**
Ice Hockey, Inline Hockey,
Figure Skating, Synchronized Skating
- 29 Football, Rugby, Soccer, Lacrosse**
- 30 Golf**
- 31 Soccer / Flag Football**
- 32 Tennis**
- 33 Volleyball**

> Contact Information

Gwinnett Sports Commission

Robert L. Patton, *Sports Marketing Director*
 6500 Sugarloaf Parkway, Suite 200
 Duluth, GA 30097
 770-814-6042 Phone
 770-623-1667 Fax
 rpatton@gcvb.org

www.gwinnettsportscommission.org

2010/2011 Sports Calendar

MAY

ECHO Hockey South Regional,
SGAA Dual Deck Arena, Snellville

2010 Warrior Spring Fever Lacrosse Tournament,
Rabbit Hill Park, Dacula

Collins Hill Junior Spring Classic,
Collins Hill Athletic Club, Lawrenceville

2010 USA Wrestling Southeast Regionals,
Gwinnett Center, Duluth

2010 Nike Bobby Hussey Memorial Day Classic,
Suwanee Sports Academy

JUNE

Collins Hill Junior Grand Prix Championships,
Collins Hill Athletic Club, Lawrenceville

2010 Tour Cup Series Regional Qualifier,
SGAA Dual Decks Arena, Snellville

2010 2Hot4Ice National Championships

JULY

Collins Hill Junior Holiday Classic Championships,
Collins Hill Athletic Club, Lawrenceville

USA Judo Championships,
Gwinnett Center, Duluth

Gwinnett Bike Fest,
(multiple venues, multiple days)

AUGUST

Collins Hill Junior Super Satellite,
Collins Hill Athletic Club, Lawrenceville

SEPTEMBER

Collins Hill Athletic Club Junior Satellite,
Collins Hill Athletic Club, Lawrenceville

OCTOBER

Collins Hill Athletic Club Championships Fall Classic,
Collins Hill Athletic Club, Lawrenceville

13th Annual Petit Le Man,
Road Atlanta, Braselton

NOVEMBER

Collins Hill Jr. Autumn Classic Championships,
Collins Hill Athletic Club, Lawrenceville

DECEMBER

Collins Hill Jr. Christmas Classic Satellite,
Collins Hill Athletic Club, Lawrenceville

2011 AND BEYOND

2011 PGA Tour Championship,
Atlanta Athletic Club, Duluth

2012 SEC Women's Gymnastics Championships,
the Arena at Gwinnett Center, Duluth

2013 SEC Women's Basketball Championships,
the Arena at Gwinnett Center, Duluth

2014 SEC Women's Basketball Championships,
the Arena at Gwinnett Center, Duluth

> About Us



SEC WOMEN'S BASKETBALL CHAMPIONSHIP, GWINNETT ARENA

Gwinnett Sports Commission "Don't PLAY without US!"

Welcome to Gwinnett County, Georgia! The mission of the Gwinnett Sports Commission (GSC) is to foster economic development through coordinating and developing Gwinnett's role as a leading site for sports events involving youth, collegiate, amateur and professional organizations. Located just 30 minutes north of downtown Atlanta off of I-85, Gwinnett encompasses 15 cities (including Duluth, Norcross, Suwanee, Buford, Lawrenceville and Lilburn) and is the home of the Arena at Gwinnett Center, Suwanee Sports Academy, Racquet Club of the South, SGAA Athletic In-Line Hockey Complex, the TPC at Sugarloaf and the parks and facilities of Gwinnett County Parks and Recreation, named as the #1 Parks and Recreation department in the nation by the National Parks Association.

The Gwinnett Sports Commission Facilities Guide is designed to highlight Gwinnett venues capable of hosting local, regional, national and international sporting events. This guide provides general information on each sports facility, including diagrams for larger multi-purpose facilities. You will also find information on accommodations, area attractions and transportation.

WHY GWINNETT?

Everything you need to ensure the success of your event can be found in Gwinnett County. The GSC will provide the resources and services that you need to make your event a resounding success.

The GSC can provide you with assistance on all aspects of your event. **Give us your game plan and leave the rest to us!** As the Gwinnett Convention and Visitors Bureau's Sports Marketing division, the GSC knows Gwinnett sports better than anyone. The GSC is continually updating our information so that you plan your event more efficiently.

Not only will our services save you time, energy and long-distance phone bills, most importantly there is **NO CHARGE** for these services.

FACILITY AND HOUSING SERVICES

- Look for the best rates, or narrow the search to a specific area or hotel chain
- Collect hotel and facility bid proposals and provide them to you in a professionally compiled presentation
- Conduct site inspections of venues and hotels

MARKETING AND PROMOTION

- Coverage through the GCVB's media/online outlets, including Facebook
- Coverage in the Gwinnett Convention and Visitors Bureau's newsletter
- Coverage in the GSC's calendar of events
- Website links on www.gwinnettsportscommission.org
- Marketing and selling of tickets
- Sponsorship fulfillment for Sport Event Owners
- Recruitment of volunteers
- Supervising event preparation

> About Us

WHAT TO DO AT THE END OF COMPETITION?

Gwinnett is easily accessible to downtown Atlanta, and metro Atlanta is full of activities and events for your participants and spectators when competition day is complete. Atlanta is a hotspot for sports, including the NFL **Atlanta Falcons**, the NHL **Atlanta Thrashers**, the NBA **Atlanta Hawks** and the WNBA **Atlanta Dream**. Gwinnett is the home of two professional teams, the MLB Atlanta Braves AAA affiliate, the **Gwinnett Braves**, as well as the **Gwinnett Gladiators** (minor league affiliate of the NHL Atlanta Thrashers). The **Gwinnett Braves** play in the state-of-the-art Coolray Field, opened in 2009.

If music and dancing are more your speed, you'll feel right at home in America's largest country music and dance hall – **Wild Bill's!** Named by the Country Music Association as the #2 Country Music Venue in the nation, Wild Bill's has live concerts, a great house band, huge dance floor and more!



BERM SEATS AT COOLRAY FIELD (GWINNETT BRAVES)

Shopping is the official sport of the locals, and Gwinnett is certainly leading the race. **Mall of Georgia** is the largest mall in the Southeast, full of 225 anchor stores, entertainment and restaurants. But if competition for bargains is more your game, you won't want to bypass **Discover Mills** outlets and 'shoppertainment.' **Dave & Buster's** Sugarloaf provides entertainment experiences including video, virtual reality, racing games, bowling, billiards and pop-o-shot basketball, just what your athletes need to wind down after a hard day. Moms will love boutiques and shops at the new **Forum Shops at Peachtree Parkway**, **The Avenue at Webb Gin** or **Gwinnett Place Mall**.



STONE MOUNTAIN PARK

Gwinnett County and metro Atlanta offer lots of excursions while you are in town. Consider checking out...

- **Georgia Aquarium** – www.georgiaaquarium.com
- **World of Coke** – www.worldofcoke.com
- **Stone Mountain Park** – www.stonemountainpark.com
- **Malibu Grand Prix** – www.malibugrandprix.com
- **Six Flags Over Georgia** – www.sixflags.com
- **Centennial Olympic Park** – www.centennialpark.com

Or see complete "things to see and do" on our website – www.visitgwinnettcountry.org.

PROFESSIONAL TEAMS:

- **MLB Atlanta Braves** – www.atlantabraves.com
- **NFL Atlanta Falcons** – www.atlantafalcons.com
- **NHL Atlanta Thrashers** – www.atlantathrashers.com
- **NBA Atlanta Hawks** – www.atlantahawks.com
- **WNBA Atlanta Dream** – www.wnba.com/dream
- **Gwinnett Braves AAA Baseball** – www.gwinnettbraves.com
- **ECHL Gwinnett Gladiators Hockey** – www.gwinnettgladiators.com

The Gwinnett Sports Commission can not only help plan your outside activities, but will assist in securing tickets and group blocks for any event.

Remember when planning your competition, camp
or sports meeting...**SUCCESS PLAYS HERE!**

> Facilities



Arena at Gwinnett Center

6400 Sugarloaf Parkway, Duluth GA 30097
770-813-7500 • www.gwinnettcenter.com

Triple axels, slapshots, dismounts and break-away dunks are just a few of the things happening at the Arena at Gwinnett Center. The Arena is the Southeast's venue of choice for regional and national events, including: the 2010, 2013 and 2014 SEC Women's Basketball Championships, the 2012 SEC Gymnastics Championships, the 2009 FLW Family Fest and Weigh-In, the 2009 NCAA Women's Round I and II national basketball championships, Georgia High School state wrestling and basketball championships, plus numerous other regional competitions.

The Arena is the home venue of the ECHL Gwinnett Gladiators hockey team, who are also the minor league affiliate of Atlanta's professional hockey team, the Thrashers. The Arena has been regionally and nationally recognized by *Billboard and Pollstar* magazine as their "Mid-Sized Venue of the Year," as well as by the *Atlanta Business Chronicle* as metro Atlanta's "Deal of the Decade." The facility has garnered acclaim for its clean architectural lines, superior customer service, fan-friendly layout and 4,900 free parking spaces. The Arena can accommodate groups from 3,500 to 13,000 for a sporting event or concert. The beautifully landscaped environment, and state-of-the-art lighting and acoustics guarantee a enjoyable event. The house reduction system allows staff to scale back seating with the touch of a button.

Amenities include:

- 35 corporate suites, 2 party suites
- Permanent Ice Floor
- 4,900 free parking spaces
- Wider seats
- Plentiful handicapped accessible seating
- State of the art house reduction system
- 13 locker rooms
- TV and green rooms
- Full operations, sales & marketing staff



> Facilities

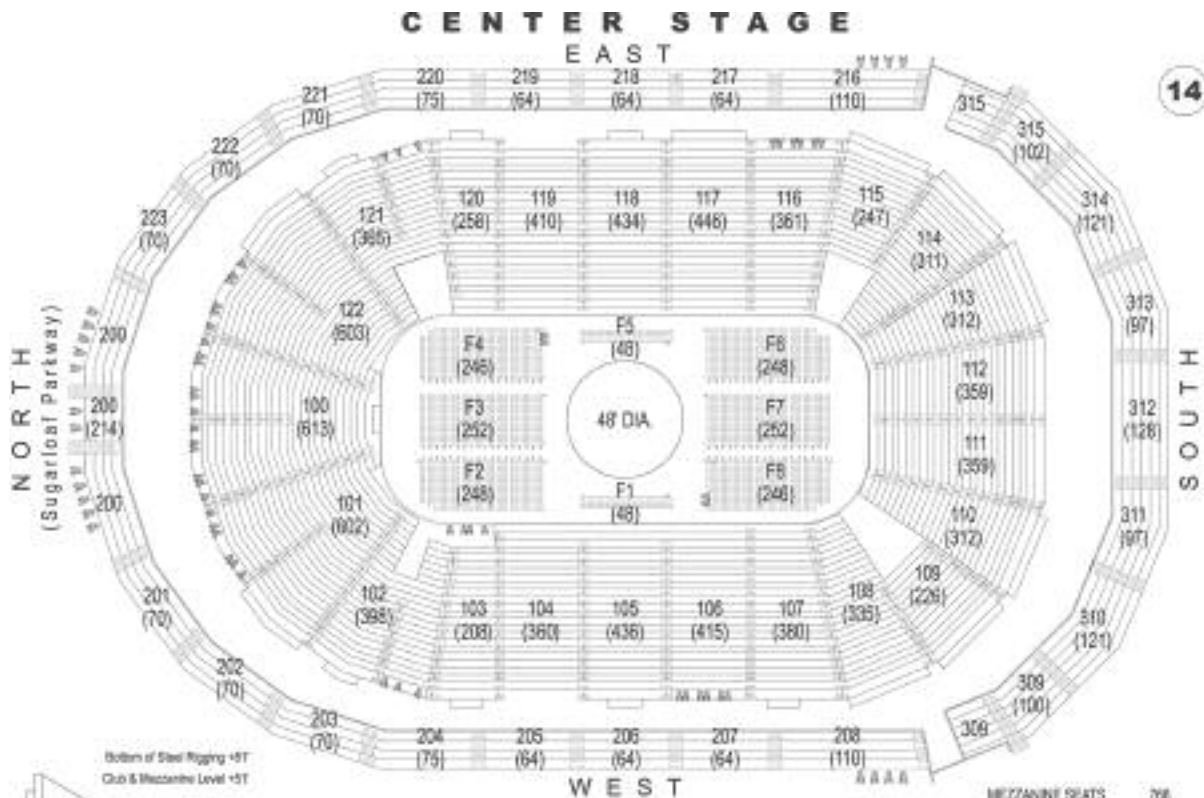

MEZZANINE SEATS	706
CLUB SEATS	1,398
CONCOURSE SEATS	8,750
FLOOR SEATS	1,586
TOTAL	12,442

THE ARENA AT GWINNETT CENTER

> Facilities

Gwinnett Center

6400 Sugarloaf Parkway, Duluth GA 30097
770-813-7500 • www.gwinnettcenter.com

The Gwinnett Center (GC) is one of the most unique convention facilities in the state of Georgia. The center is just 30 minutes north of Atlanta and offers an appealing alternative to events downtown. This modern and comfortable facility is an excellent choice for indoor sporting events, including gymnastics, cheerleading and the martial arts. Gymnastics, cheerleading and martial arts are just a few of the types of events held at the GC.

The GC is made up of 50,000 square feet of exhibit space, a 21,600 square foot Grand Ballroom and 23 meeting rooms that can accommodate small and large groups alike.

The Exhibit Hall can host trade shows, conventions, consumer shows and sporting events. With three unique partitions, this facility can be configured to accommodate events requiring 10,000 to 50,000 square feet.

If you need an event office, hospitality room, equipment room or on-site meeting space, the GC has 23 versatile meeting rooms that can be configured for events from 2 to 1,000 attendees.

The “five-star” Grand Ballroom is the crowning touch. The 21,600 square foot Grand Ballroom also meets the demand for additional exhibit and break-out space. The Grand Ballroom’s 7 salons and the 10,000 square feet of lakeside pre-function space can be configured into rooms from 1,800 to 21,600 square feet.

1,000 people in a banquet setting or a major trade show are equally at home in the Grand Ballroom. All meeting spaces in the Grand Ballroom have high-speed data lines for internet access and video conferences, as well as sophisticated video projection equipment.



GWINNETT CENTER AMENITIES INCLUDE:

- 28-foot ceilings
- Unlimited load-bearing floor
- Drive-in access
- Nine loading docks
- Floor level electricity and custom-designed sound system
- Fully handicap accessible
- In-house catering by Proof of the Pudding
- 50,000 square-foot column free space
- Professional sales, security and set-up staff on-site
- 4,200 spaces of free parking
- Free high-speed Internet
- Superior Customer Service

> Facilities

Gwinnett Center

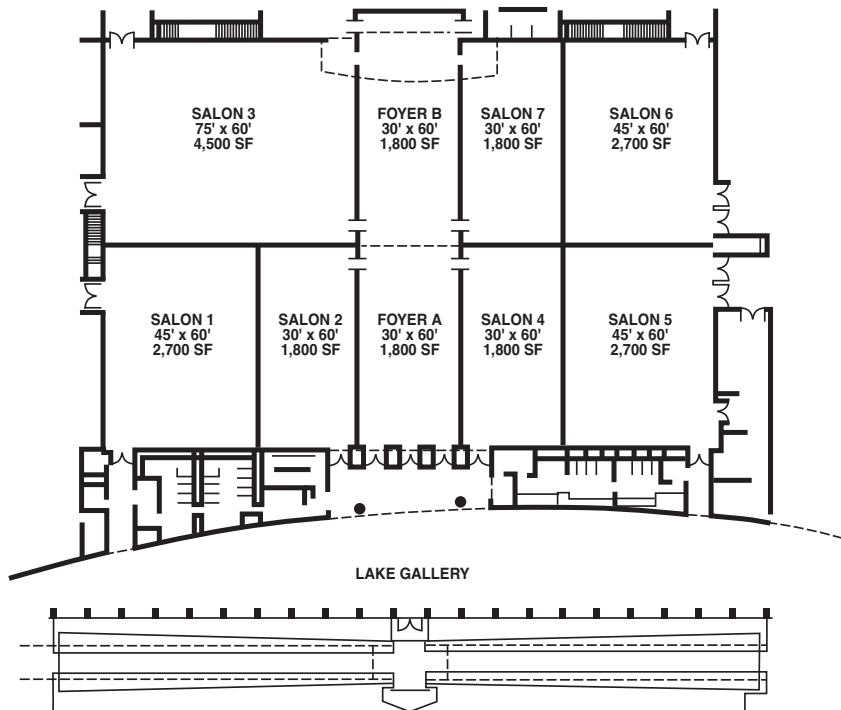

Grand Ball Room

> Facilities



"Where Athletes Train, Compete and Achieve"

Suwanee Sports Academy

3640 Burnette Road, Suwanee GA 30024
770-614-6686 • www.ssasports.com

This facility is unlike any other sports facility in metro Atlanta. The Suwanee Sports Academy has over 100,000 square feet of space, including 7 NBA regulation basketball courts and 11 regulation volleyball courts, one of the largest number of private facility courts in the U.S. Entire national competitions are held here, all under one roof in a clean, safe and climate controlled environment. This multipurpose facility offers flexibility to any event planner, utilizing a pick-and-choose system of options where a group can tailor make its configuration (i.e. set-up, concessions or bleachers). With a full range of amenities, professional staff, flexible space and plentiful spectator seating, the Suwanee Sports Academy is an ideal venue for both regional and national competitions.

AMENITIES:

- | | | |
|--|---|--|
| <ul style="list-style-type: none"> • Movable bleachers • Concession stands • Meeting rooms • Locker rooms with showers | <ul style="list-style-type: none"> • Workout facility • 1/6 Indoor track • Mark Price Shooting Lab | <ul style="list-style-type: none"> • 15,000 sf off-court performance training area • On-site physical therapy center • Meeting & conference space |
|--|---|--|

> Facilities



"Recognized as One of the World's Best Road Courses"

Road Atlanta

5300 Winder Highway, Braselton GA 30517
770-967-6143 • www.roadatlanta.com

Road Atlanta is a 2.54 mile, 12-turn world-class track providing tricky turns for racers, while providing incredible views for spectators. The facility is utilized for a wide variety of events, including professional and amateur sports car and motorcycle races, racing and driving schools, corporate programs and testing for motorsports teams.

Road Atlanta is fan-friendly, with additional measures in place to ensure ease of access for physically challenged guests.



ROAD ATLANTA EVENTS:

- Petit Le Mans
- Suzuki Superbike Showdown
- SCCA Nationals/Road Race of Champions
- Drift Atlanta
- WERA Cycle Jam/Grand Nationals
- Historic Sportscar Racing Mitty Speedfest
- Year One Experience
- World Karting Association
- 25th Anniversary Spec Ford Race
- NASA Race Series

> Facilities

Racquet Club of the South



Racquet Club of the South

6350 Courtside Dr, Norcross GA 30092
770-449-6060 • www.rcstennis.com

Nestled in a beautifully wooded setting in Peachtree Corners/Norcross, this newly renovated 23-acre facility is a certified regional USTA training center as well as metro Atlanta's top indoor tennis facility. The Club is also the home base for U.S. Open phenom Melanie Oudin.

FACILITIES INCLUDE:

- 18 outdoor-lighted Har-Tru courts
- 3,000-seat stadium court
- 8 indoor climate controlled courts
- 4 well-groomed clay courts
- 25 meter swimming pool and workout facility
- Full-service restaurant and bar that overlooks the stadium court
- Full-service pro shop
- Locker rooms

The Racquet Club of the South has been home to the *Atlantic Coast Conference Collegiate Championships*, as well as numerous USTA and Atlanta Lawn Tennis Association events.

Collins Hill Athletic Club

100 Countryside Place,
Lawrenceville GA 30043
678-985-9004

www.collinshillathleticclub.com

A privately-owned, full-service facility prepared to exceed the needs for any tournament or event.

FACILITIES INCLUDE:

- 18 courts (hard/clay)
- Hydro courts
- Full-service restaurant
- Swimming pool
- Meeting and banquet facilities
- Tennis Pro and Pro Shop on-site

> Park Locations

Gwinnett County's Parks and Recreation Department (GCPR) was recently named (2008) as the nation's top Parks and Recreation department by the National Parks Association! With over 40 parks and more in development, visitors and residents will find a bevy of amenities at every park, with clean, safe restrooms, playgrounds and walking trails. GCPR offers a full range of classes, programs and special events year-round. View their offerings online.

1. Shorty Howell Park, 2750 Pleasant Hill Rd, Duluth
2. Best Friend Park & Pool, 6224 Jimmy Carter Blvd, Norcross
3. Jones Bridge Park, 4901 East Jones Bridge Rd, Norcross
4. Dacula Park & Pool, 205 Dacula Rd, Dacula
4. Dacula Activity Building, 2735 Old Auburn Rd, Dacula
5. Mountain Park Park, 5050 Five Forks-Trickum Rd, Lilburn
6. Lucky Shoals Park, 4651 Britt Rd, Norcross
7. George Pierce Park, 55 Buford Highway, Suwanee
8. Harmony Grove Soccer Complex,
119 Harmony Grove Rd, Lilburn
9. Singleton Road Activity Building,
5220 Singleton Rd, Norcross
10. Cemetery Field, 211 Cemetery St, Norcross
11. Lawrenceville Female Seminary/Gwinnett History Museum,
455 S. Perry Street, Lawrenceville
12. Collins Hill Park, 2000 Collins Hill Rd, Lawrenceville
12. Collins Hill Park Aquatic Center,
2200 Collins Hill Rd, Lawrenceville
13. Gwinnett Historic Courthouse,
185 West Crogan St, Lawrenceville
14. Lenora Park & Pool, 4515 Lenora Church Rd, Snellville
15. Rhodes Jordan Park & Pool,
100 East Crogan St, Lawrenceville
16. Tribble Mill Park, 2125 Tribble Mill Parkway, Grayson
17. Bethesda Park & Aquatic Center,
225 Bethesda Church Rd, Lawrenceville
18. Bogan Park & Aquatic Center, 2723 N. Bogan Rd, Buford
19. Yellow River Park, 3232 Juhan Rd, Stone Mountain
20. Pinckneyville Community Center,
4650 Peachtree Industrial Boulevard, Norcross
20. Pinckneyville Park, 4758 S. Old Peachtree Rd, Norcross
20. Pinckneyville Park Soccer Complex,
4707 S. Old Peachtree Rd, Norcross
21. Rabbit Hill Park, 400 Rabbit Hill Road, Dacula
22. Yellow River Post Office Park site, Lilburn
Public tours by appointment only
23. Mountain Park Aquatic Center & Activity Building,
1063 Rockbridge Rd, Stone Mountain
24. Bay Creek Park, 175 Ozora Rd, Loganville
25. Ronald Reagan Park, 2777 Five Forks Trickum Rd,
Lawrenceville
26. Little Mulberry Park, 3855 Fence Rd, Auburn
27. McDaniel Farm Park, 3251 McDaniel Rd, Duluth
28. Vines Gardens, 3500 Oak Grove Rd, Loganville
29. Lions Club Park, 5500 Rockbridge Circle, Lilburn
30. South Gwinnett Park, 2015 McGee Rd, Snellville
31. Holcomb Bridge Park, 4300 Holcomb Bridge Rd, Norcross
32. Gwinnett Environmental & Heritage Center,
2020 Clean Water Drive, Buford
33. Graves Park, 1540 Graves Rd, Norcross
34. Sweet Water Park, 800 Bethesda School Rd, Lawrenceville
35. DeShong Park, 2859 North DeShong Rd, Stone Mountain
36. West Gwinnett Park & Aquatic Center,
4488 Peachtree Industrial Boulevard, Norcross
37. Peachtree Ridge Park, 3117 Suwanee Creek Rd, Suwanee
38. Duncan Creek Park, 3700 Braselton Highway, Dacula
39. Rock Springs Park, 550 Rock Springs Rd, Lawrenceville
40. Club Drive Park, 3330 Club Drive, Lawrenceville
41. Alexander Park, 800 Old Snellville Highway, Lawrenceville
42. Harbins Park, 2995 Luke Edwards Rd, Dacula
43. Settles Bridge Park, 380 Johnson Rd, Suwanee
44. Freeman's Mill Park, 1401 Alcovy Rd, Lawrenceville

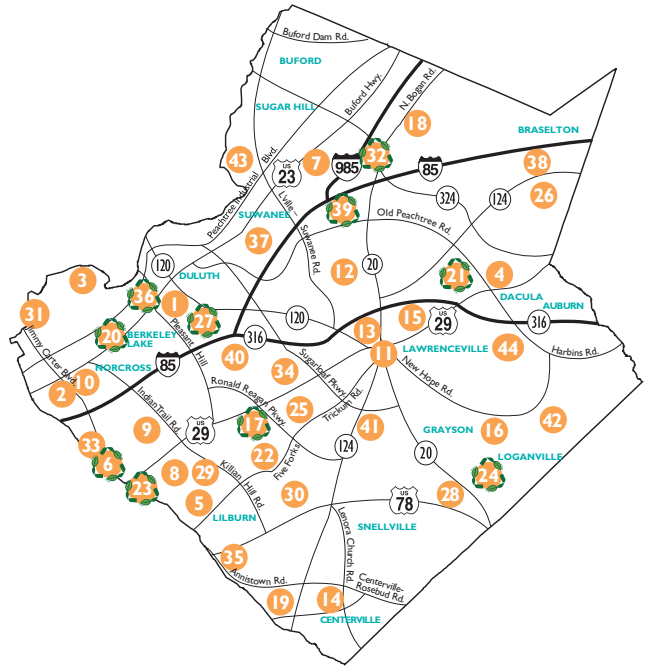

> Facilities



Atlanta Ice Forum

2300 Satellite Blvd, Duluth GA 30097
770-813-1010 • www.iceforum.com

The Ice Forum/Duluth is the official practice facility for both the National Hockey League's Atlanta Thrashers and the ECHL Gwinnett Gladiators. With NHL regulation size ice surfaces, the Forum can accommodate any level of skating or hockey event. The Forum also features the Breakaway Grill, a full-service restaurant that overlooks the practice ice.

FACILITY AMENITIES INCLUDE:

- 15,000 square-foot training complex
- 2 NHL-regulation sheets of ice (200 x 85)
- Spectator seating
- Large concourse
- 8 locker rooms with showers
- Full-service snack bar
- Full-service Pro Shop
- Skate sharpening and repair service
- Ample, free parking for 400 vehicles

South Gwinnett Park/ SGAA Dual Deck Arena

2115 McGhee Road, Snellville GA 30078
404-570-SGAA • www.sgaasports.com

This 44,000 sq. ft. open air facility features two regulation rinks. The facility is now home to 100 teams in the AARHO and GHRA middle/high school programs, three sessions of youth and adult play, Southeastern Conference Collegiate games, and Regional and National events for 2HOT4ICE, TORHS, ECHO, COASTAL CUP, and AAU. State Wars and Team USA also utilize the facility represent their sport in international competition.

FACILITY AMENITIES INCLUDE:

- 2 Rinks
- 1,000 person capacity
- Concession Stand
- 8 Locker Rooms
- Pro Shop

The Dual Deck Arena hosts over 20 events annually, including the AIHL Festival, 2 Hot 4 Ice Regional/National; AAHRO Championships; ECHO Regional and National Championships; TORHS ACC Championship and others.



> Facilities

Gary Pirkle Park

6195 Austin Garner Road, Sugar Hill GA 30519
770-831-7413 • www.cityofsugarhill.com

Newly opened, Gary Pirkle Park is a 67 acre park featuring a paved, lighted 1.7 mile walking trail. The park has 5 multi-purpose fields (3 synthetic turf fields (255,000 sq. ft, largest in the Southeast) and 2 natural grass fields.

There's also a giant 90' playground pavilion with solar power, a concession building, covered viewing pavilions and grandstands. The fields are configured for soccer and can be used for lacrosse and football.



FACILITIES INCLUDE:

- State of the art field lights
- A unique covered bridge
- Several smaller trail bridges
- Lighted vehicle bridge.
- Community Garden
- Activity Barn



Gwinnett County Housing Services

Why pay a housing bureau part of your revenue when the Gwinnett Sports Commission provides all of the services of a housing bureau at **NO CHARGE**? Don't waste your valuable time and money contacting each hotel individually, give the GSC all the information and let us do the work! We will find the best housing options for your event. From rate, rebates, site visits, contracts we will do it all. Just ask.

All accommodations are conveniently located for easy access to area transportations, venues, golf courses and attractions.

(FS) Denotes Full Service Hotel

DULUTH

(FS) ATLANTA MARRIOTT GWINNETT PLACE

1775 Pleasant Hill Rd., Duluth 30096 • 770-923-1775

www.marriottgwinnettplace.com

Indoor/outdoor pool, new "Revive" bedding package, shuttle, concierge, newly renovated, restaurant, lounge, whirlpool

CANDLEWOOD SUITES

3665 Shackelford Rd., Duluth 30096 • 678-380-0414

www.candlewoodsuites.com

Newly renovated, all suites with full kitchens, free high-speed Internet, Priority Club Points

COMFORT SUITES

3700 Shackelford Rd., Duluth 30096 • 770-931-9299 • www.sapnahotels.com

Wireless Internet, weekly manager's reception, 100% satisfaction guaranteed

COUNTRY INN & SUITES DULUTH

3530 Breckinridge Blvd., Duluth 30096 • 678-405-2900

www.countryinns.com/duluth

LCD TV's in all rooms, indoor heated pool, free breakfast

COURTYARD BY MARRIOTT GWINNETT MALL

3550 Venture Parkway, Duluth 30096 • 770-476-4666

www.gwinnettmallcourtyard.com

Newly renovated with upgraded bedding, free high-speed Internet, Marriott Rewards

DAYS INN GWINNETT PLACE

1920 Pleasant Hill Rd., Duluth 30096 • 770-476-8700 • www.daysinn.com

Whirlpool rooms, in-room coffeemakers/hairdryers, free high-speed Internet

EXTENDED STAY DELUXE

3390 Venture Parkway, Duluth 30096 • 770-623-6800

www.extendedstaydeluxe.com

Newly renovated, coffeemakers, free continental breakfast

HAMPTON INN & SUITES

1725 Pineland Rd., Duluth 30096 • 770-931-9800

www.hamptonatlantagwinnett.com

Free high-speed Internet, free breakfast, free local calls and evening social

HILTON GARDEN INN SUGARLOAF

2040 Sugarloaf Circle, Duluth 30097 • 770-495-7600

www.atlantaneagwinnettsugarloaf.hgi.com

In-room micro/fridge, free 5-mile shuttle, free high-speed Internet



ATLANTA MARRIOTT GWINNETT PLACE

HOLIDAY INN EXPRESS

3670 Shackelford Rd., Duluth 30096 • 770-935-7171 • www.sapnahotels.com

High-speed Internet access, in-room coffeemakers/hairdryers, free breakfast

(FS) HOLIDAY INN GWINNETT CENTER

6310 Sugarloaf Parkway, Duluth 30097 • 770-476-2022

www.holiday-inn.com/gwinnettcntr

Full-service, free high-speed Internet access, in-room coffeemaker, lounge, free shuttle, walking distance to Gwinnett Center

(FS) HOLIDAY INN GWINNETT PLACE AREA

1948 Day Drive, Duluth 30097 • 770-814-2800 • www.ichotelsgroup.com

All new Holiday Inn prototype, minutes from I-84, full service, Kids Stay and Eat Free, high-speed Internet

HYATT PLACE GWINNETT MALL

3530 Venture Pkwy, Duluth 30096 • 770-623-9699 • www.hyattplace.com

In-room 42" Flat Panel TV's, 24-hour dining, coffee/wine café, free shuttle

INTOWN SUITES DULUTH

3750 Satellite Blvd., Duluth 30096 • 770-622-9700 • www.intownsuites.com

Minutes from shopping and dining at Gwinnett Place Mall

LAQUINTA DULUTH

2370 Stephens Center Drive, Duluth 30096 • 678-957-0500 • www.lq.com

Free high-speed Internet access, in-room coffeemaker, free deluxe breakfast with Belgian waffles

QUALITY INN/GWINNETT MALL

3500 Venture Parkway, Duluth 30096 • 770-623-9300

www.qualityinnatlanta.com

Free local calls, in-room coffee, complimentary newspaper, free high-speed Internet, close to shopping/dining

> Housing Services

RESIDENCE INN GWINNETT PLACE

1760 Pineland Rd, Duluth 30096 • 770-921-2202 • www.marriott.com/atlgw
Newly renovated, free hot buffet breakfast, free high-speed Internet, full kitchens

STUDIO 6

3525 Breckinridge Blvd., Duluth 30096 • 770-931-3113
Free HBO, local calls, in-room dataports

SUBURBAN EXTENDED STAY

2350 Stephens Center Drive, Duluth 30096 • 678-474-9700
www.suburbanhotels.com
In-room coffeemaker/dataports, free newspaper, free high-speed Internet

SUN SUITES OF GWINNETT

3720 Steve Reynolds Blvd., Duluth 30096 • 770-931-3320 • www.sunsuites.com
In-room coffeemakers, dataports, free local calls

WINGATE BY WYNDHAM GWINNETT PLACE

3450 Venture Parkway, Duluth 30096 • 770-622-7277
www.wingateinnduluth.com
Free high-speed wireless Internet, free hot breakfast buffet, room service, suites available, newly renovated

BUFORD, MALL OF GEORGIA

AMERICA'S BEST VALUE INN

4267 Buford Drive, Buford 30518 • 770-932-0111
www.americasbestvalueinn.com
Free newspaper, newly renovated

COUNTRY INN & SUITES MALL OF GEORGIA

1395 Mall of Georgia Blvd., Buford 30519 • 770-271-1441
www.countryinns.com/bufordga
In-room coffeemakers, free Internet access, free paper, whirlpool

HAMPTON INN MALL OF GEORGIA

3240 Buford Drive, Buford 30519 • 678-546-1200
www.hampton-inn.com/hi/atl-mallofga
New Cloud 9 bedding, free newspapers, free breakfast, free HBO

HOLIDAY INN EXPRESS & SUITES

2499 Satellite Blvd., Buford 30518 • 678-318-1080 • www.hiexpress.com
Suites available, high-speed Internet access, outdoor heated spa

SPRINGHILL SUITES BY MARRIOTT

3250 Buford Drive, Buford 30519 • 678-714-2150
www.springhillsuites.com/atlbf
All studio suites, free hot breakfast buffet, free high-speed Internet

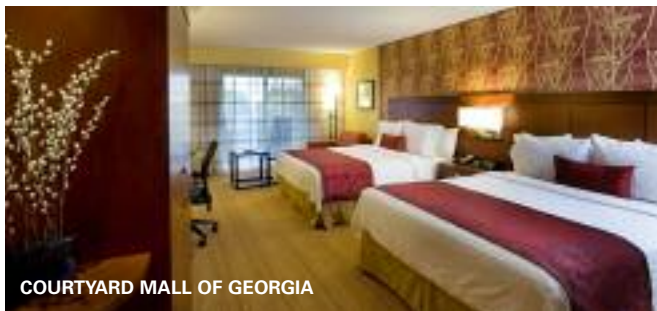

COURTYARD MALL OF GEORGIA

WINGATE INN MALL OF GEORGIA

1355 Mall of Georgia Blvd., Buford 30519 • 678-714-0248
www.wingateinns.com
Free high-speed Internet access, in-room coffeemakers/hairdryers, 2-line speakerphones, free local calls

LAWRENCEVILLE

COMFORT SUITES LAWRENCEVILLE

2225 Riverside Parkway, Lawrenceville 30043 • 678-377-0003
www.comfortsuites.com
In-room coffeemaker, upscale furnishings, 100% satisfaction guaranteed, newly renovated

COUNTRY INN & SUITES LAWRENCEVILLE

989 Duluth Hwy, Lawrenceville 30043 • 770-339-1991
www.countryinns.com/lawrencevillega
J.D. Powers Guest Satisfaction Award winner; free paper, free high-speed Internet, free deluxe breakfast

HAMPTON INN ATLANTA NE SUGARLOAF

6010 Sugarloaf Pkwy, Lawrenceville 30043 • 678-407-0018
www.atlantasugarloaf.hamptoninn.com
Deluxe "Cloud Nine" bedding, free high-speed Internet, free hotel shuttle, within 1/2 mile of Arena/Gwinnett Center

HAMPTON INN, LAWRENCEVILLE

1135 Lakes Parkway, Lawrenceville 30043 • 770-338-9600
www.hampton-inn.com/hi/atl-lawrenceville
Free newspaper, local calls, free hot breakfast, free high-speed Internet

HOMEWOOD SUITES SUGARLOAF

1725 N. Brown Rd., Lawrenceville 30043 • 770-277-1243
www.homewoodsuites.com
Free high-speed Internet, garden terrace, 24-hour sweet shop, free shuttle

NORCROSS, PEACHTREE CORNERS

ALL ROUND LODGE

3175 Medlock Bridge Rd., Norcross 30071 • 770-729-0767

AMERICA'S BEST INN

6045 Oakbrook Parkway, Norcross 30093 • 770-449-7322
www.americasbestinn.com
Free continental breakfast

(FS) ATLANTA MARRIOTT NORCROSS

475 Technology Parkway, Norcross 30092 • 770-263-8558
www.marriott.com/atlcp
Sauna, whirlpool, car rental, lounge, full service, high-speed Internet, concierge level

BEST WESTERN PEACHTREE CORNERS

7035 Jimmy Carter Blvd., Norcross 30092 • 770-409-0004
www.bestwestern.com/peachtreecorners
Free local calls, free newspapers, in-room coffeemakers/dataports, high-speed Internet

COMFORT INN & SUITES

5200 Peachtree Industrial Blvd., Norcross 30071 • 770-263-8883
www.comfortconferencecenter.com
Jacuzzi rooms, free local calls, 100% satisfaction guarantee

> Housing Services

COUNTRY INN AND SUITES

5970 Jimmy Carter Blvd., Norcross 30071 • 770-449-5051
www.countryinns.com/norcrossga
Free high-speed Internet access, in-room coffeemaker, dataports

COURTYARD BY MARRIOTT I-85/NE

6235 McDonough Drive, Norcross 30093 • 770-242-7172
www.norcrosscourtyard.com
Newly renovated with deluxe bedding package, free high-speed Internet

COURTYARD BY MARRIOTT PEACHTREE CORNERS

3209 Holcomb Bridge Rd., Norcross 30092 • 770-446-3777
www.peachtreecornerscourtyard.com
Newly renovated, free high-speed Internet, 24-hour marketplace

DAYS INN ATLANTA N.E.

5990 Western Hills Drive, Norcross 30071 • 770-368-0218
www.daysinn-atlanta.com
Free cable/HBO, 5 sunburst rated, Jacuzzi rooms

DAYS INN & SUITES

5385 Peachtree Industrial Blvd., Norcross 30092 • 770-416-9021 • www.daysinn.com
Whirlpool rooms, free high-speed Internet access, in-room hairdryers/dataports

DRURY INN & SUITES

5655 Jimmy Carter Blvd., Norcross 30071 • 770-729-0060 • www.druryhotels.com
Newly renovated, free breakfast, indoor pool, free evening reception

EXTENDED STAY AMERICA

6295 Jimmy Carter Blvd., Norcross 30071 • 770-446-9245
In-room coffeemakers, hairdryers, dataports

EXTENDED STAY AMERICA

200 Lawrenceville St., Norcross 30071 • 770-792-8100

(FS) GARDEN PLAZA HOTEL PEACHTREE CORNERS

6050 Peachtree Ind. Blvd, Norcross 30071 • 770-448-4400
Free high-speed Internet, free shuttle within 3 miles

GUEST HOUSE INN

2050 WillowTrail Parkway, Norcross 30093 • 770-564-0492
www.guesthouse.net
In-room coffeemakers, free local calls & health club privileges, dataports

HAMPTON INN -PEACHTREE CORNERS/NORCROSS

440 Technology Parkway, Norcross 30092 • 770-729-0015
www.hamptoninn.com/hi/atl-norcross
Free high-speed Internet, free hot breakfast, indoor whirlpool

(FS) HILTON ATLANTA NORTHEAST

5993 Peachtree Industrial Blvd., Norcross 30092 • 770-447-4747
www.atlantaneast.hilton.com
Full-service, Serenity beds, free WiFi in public areas, concierge level, indoor/outdoor pool

HOMESTEAD STUDIO SUITES

7049 Jimmy Carter Blvd., Norcross 30092 • 770-449-9966
www.homesteadhotels.com
Free local calls, on-site guest laundry, free high-speed Internet

HOMEWOOD SUITES BY HILTON

450 Technology Parkway, Norcross 30092 • 770-448-4663
www.homewood-suites.com
In-room coffeemaker, hairdryer, free hot breakfast, evening reception

HORIZON INN AND SUITES

6187 Dawson Blvd, Norcross 30093 • 770-448-8686
In-room coffeemakers, cable TV with HBO

HOWARD JOHNSON

5375 Peachtree Industrial Blvd., Norcross 30092 • 770-449-5144
www.hojo.com
Pillow top mattresses, king rooms with micro/fridge

HYATT PLACE PEACHTREE CORNERS/NORCROSS

5600 Peachtree Parkway, Norcross 30092 • 770-416-7655
www.hyattplace.com
Newly renovated, café and wine bar, free shuttle

INTOWN SUITES BUFORD HWY

6067 Buford Highway, Norcross 30071 • 770-840-7778
www.intownsuites.com
Guest laundry, free local calls, voice mail/dataports

INTOWN SUITES INDIAN TRAIL

1990 Willow Trail Parkway, Norcross 30093 • 770-806-6501
www.intownsuites.com
Guest laundry, free local calls, voice mail/dataports

INTOWN SUITES NORCROSS

1950 Willow Trail, Norcross 30071 • 678-221-1050 • www.intownsuites.com
Voice mail, cable TV w/HBO, maid service

KNIGHTS INN

5122 Brook Hollow Parkway, Norcross 30071 • 770-446-5490
Immediate I-85 access

LAQUINTA INN & SUITES

5945 Oakbrook Parkway, Norcross 30093 • 770-368-9400 • www.lq.com
Newly renovated, free wireless Internet, free deluxe continental breakfast

THE LODGE AT SIMPSONWOOD

4511 Jones Bridge Rd., Norcross 30092 • 770-441-1111
www.simpsonwood.org
Conference & retreat center, 4 guest lodges, 26,000 sf meeting space, volleyball, tennis, hiking, all on-site

MICROTEL INN NORCROSS

2150 North Norcross-Tucker Rd., Norcross 30071 • 678-291-9888
www.microtelinn.com
Cable TV w/HBO, free local calls, in-room hairdryers/coffeemakers

MOTEL 6

5395 Peachtree Ind. Blvd., Norcross 30092 • 770-446-2882
www.motel.com
T-Mobile Hot Spot, guest laundry, in-room micro/fridge

MOTEL 6 NORCROSS

6015 Oakbrook Parkway, Norcross 30093 • 770-446-2311 • www.motel6.com
Cable TV with HBO

NORCROSS EXTENDED STAY

2250 Pelican Drive, Norcross 30071 • 770-417-1088
Dataports, in-room coffeemakers

RED ROOF INN NORCROSS

5171 Brook Hollow Parkway, Norcross 30071 • 770-448-8944 • www.redroof.com
In-room voice mail, immediate I-85 access

> Housing Services

RESIDENCE INN PEACHTREE CORNERS

5500 Triangle Drive, Norcross 30092 • 770-447-1714
www.marriott.com/atlps
 Free wireless high-speed Internet, free hot buffet breakfast, 2-room suites

RITE4US

5985 Oakbrook Parkway, Norcross 30093 • 770-662-8175
 Newly renovated, I-85 access, free breakfast

STUDIO PLUS PEACHTREE CORNERS

7065 Jimmy Carter Blvd, Norcross 30092 • 770-582-9984
www.studioplus.com
 Sleeper sofa, guest laundry, full kitchens

SUPER 8

6650 Bay Circle Drive, Norcross 30071 • 770-441-1999 • www.super8.com
 Dataports, free local calls/newspaper, in-room movies

SUPER 8 NORCROSS/ATLANTA N.E.

5150 Willow Oak Trail, Norcross 30093 • 770-931-5353 • www.super8.com
 Free coffee, cable/HBO, Jacuzzi rooms, 24-hour coffee

TOWNE PLACE SUITES NORCROSS

6640 Bay Circle, Norcross 30071 • 770-447-8446 • www.marriott.com/atltn
 New bedding package with cotton rich linens and deluxe mattresses,
 full kitchens and free high-speed Internet

WINGATE INN NORCROSS

5800 Peachtree Industrial Blvd., Norcross 30071 • 770-263-2020
www.wingatenorcross.com
 Free high-speed Internet access, free hot buffet breakfast, spa, pool

STONE MOUNTAIN, LILBURN

BEST WESTERN STONE MOUNTAIN

1595 East Park Place Blvd., Stone Mountain 30087 • 770-465-1022
www.bestwestern.com/stonemountainga
 Free local calls, continental breakfast, free cable, 1/4 mile from Stone Mtn Park

COMFORT INN STONE MOUNTAIN

5355 Stone Mountain Highway, Stone Mountain 30087 • 770-465-1888
www.choicehotels.com/hotel/ga287
 Free local calls, in-room coffeemaker/hairdryers, dual-line phones,
 free high-speed Internet

COUNTRY INN AND SUITES

1852 Rockbridge Rd., Stone Mountain 30087 • 770-465-6515
www.countryinns.com/stonemountainga
 Free high-speed Internet access, in-room coffeemakers/hairdryers,
 free local calls, free hot breakfast, 1/2 mile to Stone Mtn Park

DAYS INN STONE MOUNTAIN

2006 Glenn Club Drive, Stone Mountain 30087 • 770-879-0800
www.daysinn.com/stonemountainga
 Free high-speed Internet, 1/2 mile to Stone Mtn Park, free continental breakfast

GWINNETT INN

4170 Highway 78, Lilburn 30047 • 770-972-9395
 Minutes from Stone Mountain Park

HOLIDAY INN EXPRESS STONE MOUNTAIN

1790 E. Park Place, Stone Mountain 30087 • 770-465-8847
www.hiexpress.com/stonemountain
 Minutes from Stone Mountain, in-room irons/boards/hairdryers

INTOWN SUITES LILBURN

4142 Stone Mountain Highway, Lilburn 30047 • 770-736-7001
www.intownsuites.com
 Guest laundry, free local calls, voice mail/dataports

INTOWN SUITES STONE MOUNTAIN

4350 Highway 78, Lilburn 30047 • 770-972-6042 • www.intownsuites.com
 Guest laundry, free local calls, voice mail/dataports

SUWANEE

BEST WESTERN GWINNETT INN

77 Gwinco Blvd, Suwanee 30024 • 770-271-5559 • www.bestwestern.com
 Free high speed Internet, newly renovated, wireless connectivity

COURTYARD BY MARRIOTT SUWANEE

310 Gwinco Blvd., Suwanee 30024 • 770-831-7473 • www.marriott.com/atlsu
 Newly renovated, luxury bedding package, free high-speed Internet

COMFORT INN

2945 Highway 317, Suwanee 30024 • 770-945-1608 • www.comfortinn.com
 Free newspaper, in-room coffeemakers, dataports

COMFORT SUITES

2945-A Highway 317, Suwanee 30024 • 678-714-7707 • www.choicehotels.com
 Deluxe continental breakfast, high-speed Internet access, hot tub

DAYS INN SUWANEE

2955 Highway 317, Suwanee 30024 • 770-945-4921 • www.daysinn.com
 Free continental breakfast, cable TV

FAIRFIELD INN BY MARRIOTT SUWANEE

105 Gwinco Blvd, Suwanee 30024 • 770-932-9292 • www.marriott.com/atlsw
 Free newspaper, in-room coffeemakers, free wireless Internet, free continental
 breakfast

MOTEL 6

3103 Highway 317, Suwanee 30024 • 770-945-8372 • www.motel6.com
 Newly renovated

SUN SUITES OF SUWANEE

95 Gwinco Blvd., Suwanee 30024 • 770-614-0890 • www.sunsuites.com
 Guest laundry, in-room coffeemakers/voice mail

SUPER 8

317 Sawmill Drive, Suwanee 30174 • 770-614-6222 • www.super8.com
 In-room coffeemakers, dataports, hairdryers

> Local Transportation



AIRPORTS

Atlanta Hartsfield-Jackson International Airport404-209-2920
Gwinnett County/Briscoe Airport770-822-5196

AIRLINE RESERVATIONS

Air Tran.....800-247-8726
American800-433-7300
Continental800-523-3273
Delta800-221-1212
United800-864-8331
US Air800-428-4322

PUBLIC TRANSPORTATION

Gwinnett County Transit.....770-822-5010
Provides express, local and paratransit services for Gwinnett County, with express service running Monday-Friday with 6 routes utilizing I-85 HOV lanes going into Atlanta, as well as five (5) local routes. www.gctransit.com

PARK & RIDE LOTS

- I-985 Park & Ride (near Mall of Georgia)
- Discover Mills Park & Ride
- Indian Trail/I-85 Park & Ride
- 770-418-2336 (Paratransit)

METRO ATLANTA RAPID TRANSIT AUTHORITY (MARTA)

404-848-4711
Visit www.itsmarta.com for complete schedule and ticketing information.

CAR RENTAL

Rental car policies and requirements vary; always double-check your personal vehicle insurance policy to see what is already covered.

Alamo, Worldwide800-GO-ALAMO (327-9633)
Avis Rent A Car, Worldwide800-331-1212
Budget Rent-A-Car, Worldwide800-527-0700
Dollar Rent-A-Car, Worldwide800-800-3665
Enterprise Rent-A-Car, Worldwide.....800-325-8007
Hertz Rent-A-Car, Worldwide.....800-654-3131
Thrifty Car Rental, Norcross770-847-4389

HANDICAPPED ACCESSIBLE TRANSPORTATION

Gwinnett County Paratransit.....770-822-7466
Wheelchair Getaways.....770-457-9581

> Attractions

FAMILY FUN & RECREATION

Dave & Buster's

4000 Venture Drive, Duluth
770-497-1152; www.daveandbusters.com

Home to more than 55,000 square feet of racing games, virtual reality, billiard tables, restaurant and lounge.

Dave & Buster's / Sugarloaf

5900 Sugarloaf Parkway, Lawrenceville
678-847-5400; www.daveandbusters.com

Billiards, cosmic bowling, electronic simulation games, video café and dance floor! Eat, drink and play the night away!

Gwinnett Braves

One Braves Ave, Lawrenceville
678-277-0300; www.gwinnettbraves.com

See the Gwinnett Braves, the AAA Atlanta Braves affiliate, play at Coolray Field. Tickets \$6-\$16. Season runs April-September.

Gwinnett Gladiators

6400 Sugarloaf Parkway, Duluth
770-497-5100; www.gwinnettgladiators.com

Thrilling ECHL professional ice hockey action at the Arena at Gwinnett Center. Tickets \$10-\$20. Season runs October-April.

Malibu Grand Prix

5400 Brook Hollow Parkway, Norcross
770-416-7630; www.malibugrandprix.com

Malibu is a family entertainment center that offers real Indy-style racing, challenging miniature golf and video game rooms.



MEDIEVAL TIMES DINNER & TOURNAMENT

Medieval Times Dinner & Tournament

5900 Sugarloaf Parkway, Lawrenceville
1-888-WE-JOUST; www.medievaltimes.com

Medievally themed dinner & theatre where guests experience spectacular pageantry, dramatic horsemanship, swordplay, falconry, sorcery and romance while feasting on a four-course banquet!

Pirates Cove Adventure Golf

3380 Venture Parkway, Duluth
770-623-4184; www.piratescove.net

Test your putting skills in a fun-filled setting of natural wonders, lavish landscaping and delightful pirate themes.

Southeastern Railway Museum

3595 Peachtree Road, Duluth
770-476-2013; www.srmduluth.org

The SRM features 90 items of restored rolling stock including historic Pullman cars, classic steam locomotives and more. Train rides available some weekends.

Stone Mountain Park

Highway 78 East, Stone Mountain
770-498-5690; www.stonemountainpark.com

The Southeast's number one family attraction is full of new things to see and do, including the Coca-Cola Snow Mountain, Ride the Ducks Adventure, Tree House Challenge and Ride the Ducks Adventure. Hike, bike or walk through 3,300 acres of natural beauty and you won't want to miss the popular nightly Lasershow Spectacular or the 1870's town of Crossroads, full of crafters, food and fascinating townfolk. There's also shopping, dining, and a slew of other attractions and special events! Just 16 miles east of downtown Atlanta.

Wild Bill's Dance Hall

2075 Market St, Duluth
678-473-1000; www.wildbillsatlanta.com

Join Wild Bill's crowd as they rock the night away in Wild Bill's 3 VIP lounges, 16 billiard tables, restaurant and cowboy store. Ride Wild Bill's thrilling electronic bull, or enjoy one of more than 30 live performances held in the 5,000 seat concert hall.

Yellow River Game Ranch

4525 Highway 78, Lilburn
770-972-6643; www.yellowrivergameranch.com

The Yellow River Game Ranch is Georgia's premier animal attraction. Visit with more than 600 friendly animals that enjoy food and petting! There are deer, bear, buffalo, farm animals, ducks and squirrels living along a naturally wooded path by the Yellow River.

AROUND ATLANTA

Atlantic Station

171 17th St., Atlanta
404-733-1221; www.atlanticstation.com

Hip and happening nightlife district featuring IKEA, H&M, Regal Cinemas, Fox Sports Café and other restaurants, cafes and boutique shops.



GEORGIA AQUARIUM

Château Élan Winery and Resort

100 Rue Charlemagne, Braselton
678-425-0900 or 1-800-233-WINE; www.chateauelan.com

This secluded resort offers complimentary winery tours and tasting daily.

CNN Center

One CNN Center
404-827-2300 or 1-877-4CNN-TOUR; cnn.tour.com/studiotour

Take the behind-the-scenes CNN Studio Tour; reservations are required.

Georgia Aquarium

225 Baker St., Atlanta
404-581-4000; www.georgiaaquarium.org

The Georgia Aquarium features over 100,000 animals from over 500 species, many of them rare and unique, in over 8 million gallons of water. From two amazing whale sharks (the largest fish on earth), to four striking beluga whales, around every corner you'll see things you've never seen anywhere before! Families will see giant Pacific Octopus; hanging Japanese spider crabs; fierce piranha and more. Little ones will enjoy 'petting' the horseshoe crabs and stingrays, and the amazing 4-D Theatre brings our underwater world to life.

High Museum of Art

1280 Peachtree St. NE., Atlanta
404-733-4444; www.high.org

Newly expanded by Renzo Piano, the High features special exhibits, African, decorative, folk and 20th century art, photography and special exhibits.

Lake Lanier Islands Resort

7000 Holiday Road, Lake Lanier
770-932-7200 ; www.lakelanierislands.com

Enjoy the Southeast's best Beach and Water Park, horseback and bike riding, boat rides, camping, fishing, golf and more.

Martin Luther King, Jr. National Historic Site

450 Auburn Avenue, N.E., Atlanta
404-331-5190; www.nps.gov/malu

Visit the King Center site and Dr. King's grave, birth home of Dr. King, and Ebenezer Baptist Church.

World of Coca-Cola®

121 Baker St., Atlanta
404-676-5151; www.worldofcocaCola.com

Explore the complete story - past, present and future - of the world's best-known brand!. The World of Coke has opened in its fabulous new location, located next door to the Georgia Aquarium!

The new World of Coke features a thrilling 4-D Theater, the world's largest collection of Coke memorabilia, a fully functional bottling line that produces 8 oz commemorative bottles of Coca-Cola, a tasting experience from around the world where you can taste test 70 different products, and a new Pop culture gallery featuring works by Andy Warhol, Norman Rockwell.

Zoo Atlanta

800 Cherokee Avenue, S.E., Atlanta
404-624-5600; www.zooatlanta.org

Zoo Atlanta is home to nearly 1,000 animals – large, small, furry, scaly, feathered, hooved, winged, striped and horned. Habitats include the Ford African Rain Forest, the Giant Panda Exhibit, the Sumatran Tiger Forest and the Masai Mara.



WORLD OF COCA-COLA

> Request for Proposal

Gwinnett Sports Commission

EVENT CHECK SHEET

Team or Event Name: _____

Date of Event: _____

Sport: _____

Contact Name: _____

Title: _____

Address: _____

City: _____ State: _____ Zip: _____

Phone: _____ Fax: _____ Cell: _____

Email: _____ Website: _____

FACILITY COMPARISON CHART

Facility	Locker Rooms	Lights	Parking	Seating	Notes

> Request for Proposal

HOTEL REFERENCE CHART

Name	Address	Contact	Phone	Distance to Venue	Rate	Rebate

MEDICAL NEEDS

Athletic Trainers: _____ How many: _____ Time: _____ Date: _____
 Pay rate and paid by whom: _____

Ambulance: _____ How many: _____ Time: _____ Date: _____
 Pay Rate and paid by whom: _____

Doctor(s): _____ How many: _____ Specialty: _____ Time: _____ Date: _____
 Pay Rate and paid by whom: _____

Other Medical Needs: _____

Security Needs

Total Number of Security Guards Needed: _____
 Total Number of Days Needed: _____ Date(s): _____ Time: _____
 Total Number of Shifts Per Day: _____
 Job Name: (list for each shift) _____

> Request for Proposal

Job Description: (list for each shift) _____

Special Security Needs: _____

SUPPORT NEEDS

Product	Source	Total Amount Needed	Date(s)	Notes
Water/Sports Drink				
Coolers				
Ice				
Referees				
Radios/Communications				
Telephones				
Computers				
Fax/Copy Machine				
Internet Access				
Awards				
Merchandise				
Printing				
Volunteers				

Special needs or requests: _____

For further information please contact:

Robert L. Patton, Sports Marketing Director
 6500 Sugarloaf Parkway, Suite 200
 Duluth, GA 30097
 770-814-6042 Phone
 770-623-1667 Fax
 rpatton@gcvb.org

> Baseball / Softball

BAY CREEK (8 Fields)

- Outdoor, Lighted, Concessions

BEST FRIEND PARK (1 Field)

- Dimensions 350
- Outdoor, Lighted, Concessions

BETHESDA PARK (7 Fields)

- Dimensions: 120 (3 Fields), 200 (3 Fields), 300 (1 Field)
- Outdoor, Lighted, Concessions

BOGAN PARK (7 Fields)

- Dimensions: 120 (2 Fields), 175 (1 Field), 200 (2 Fields), 225 (1 Field), 300 (1 Field)
- Outdoor, Lighted, Concessions

COLLINS HILL PARK (7 Fields)

- Dimensions: 120 (2 Fields), 150 (2 Fields), 180 (1 Fields), 225 (1 Field), 300 (1 Field)
- Outdoor, Lighted, Concessions

DACULA PARK (7 Fields)

- Dimensions: 120 (1 Field), 150 (1 Field), 200 (4 Fields), 300 (1 Field)
- Outdoor, Lighted, Concessions

GEORGE PIERCE PARK (7 Fields)

- Dimensions: 120 (1 Field), 150 (1 Field), 180 (1 Field), 200 (3 Fields), 300 (1 Field)
- Outdoor, Lighted, Concessions

LENORA PARK (7 Fields)

- Dimensions: 120 (2 Fields), 180 (1 Field), 200 (2 Fields), 220 (1 Field), 295 (1 Field)
- Outdoor, Lighted, Concessions

LIONS CLUB PARK (5 Fields)

- Dimensions: 180 (1 Field), 200 (1 Field), 225 (2 Fields), 300 (1 Field),
- Outdoor, Lighted, Concessions

MOUNTAIN PARK PARK (7 Fields)

- Dimensions: 120 (2 Fields), 180 (1 Field), 200 (2 Fields), 225 (1 Field), 300 (1 Field)
- Outdoor, Lighted, Concessions

PEACHTREE RIDGE PARK (4 Fields)

- Dimensions: 150 (1 Field), 200 (1 Field), 225 (1 Field), 200 (Special Needs, 1 Field)
- Outdoor, Lighted, Concessions

PINCKNEYVILLE PARK (7 Fields)

- Dimensions: 150 (2 Fields), 200 (3 Fields), 225 (1 Field), 300 (1 Field)
- Outdoor, Lighted, Concessions

RHODES JORDAN PARK (7 Fields)

- Dimensions: 120 (2 Fields), 180 (1 Field), 200 (2 Fields), 300 (1 Field)
- Outdoor, Lighted, Concessions

SHORTY HOWELL PARK (7 Fields)

- Dimensions: 120 (2 Fields), 150 (1 Field), 200 (3 Fields), 300 (1 Field)
- Outdoor, Lighted, Concessions

SOUTH GWINNETT PARK (7 Fields)

- Dimensions: 135 (2 Fields), 165 (1 Field), 200 (3 Fields), 300 (1 Field)
- Outdoor, Lighted, Concessions



> Basketball / Bowling



BASKETBALL

SUWANEE SPORTS ACADEMY

- Square-footage of Complex: 100,000
- Number of Courts: 7
- Size of Basketball Boundaries: NBA Regulation
- Floor Type: Wood
- Seating Capacity: 5,000
- Concessions, Meeting Rooms, Locker Rooms, Press Area, PA System

ARENA AT GWINNETT CENTER

- Square-footage of Facility: 375,000
- Number of Courts: 1
- Size of Basketball Boundaries: NBA Regulation
- Floor Type: Wood
- Seating Capacity: 12,000
- Concessions, Locker Rooms, Press Area, PA System

BEST FRIEND PARK, BOGAN PARK, LENORA PARK, LUCKY SHOALS PARK, RHODES JORDAN PARK

- Number of Courts: 1
- Floor Type: Wood

BOWLING

AMF GWINNETT LANES, NORCROSS

- Number of Lanes: 32
- Meeting Room Capacity: 40

AMF SNELLVILLE LANES

- Number of Lanes: 32
- Meeting Room Capacity: 20

BRUNSWICK ZONE LILBURN

- Number of Lanes: 40
- Meeting Room Capacity: 40

BRUNSWICK ZONE PEACHTREE LANES, NORCROSS

- Number of Lanes: 40
- Meeting Room Capacity: 100

DAVE & BUSTER'S SUGARLOAF

- Number of Lanes: 15
- Meeting Room Capacity: 100

OASIS BOWLING CENTER, BUFORD

- Number of Lanes: 32
- Meeting Room Capacity: 40

STARS AND STRIKES, DACULA

- Number of Lanes: 40
- Meeting Room Capacity: 125

> Multi-Purpose Facilities



CHEERLEADING, GYMNASTICS, TABLE TENNIS, MARTIAL ARTS, WEIGHTLIFTING, WRESTLING

GWINNETT CENTER

- Square-footage of Facility:
 - Exhibit Hall: 50,000-column free space
 - 3 Separate Halls:
 - Exhibit Hall A: 20,000 sq. ft.
 - Exhibit Hall B: 20,000 sq. ft.
 - Exhibit Hall C: 10,000 sq. ft.
 - Grand Ballroom: 21,600 sq. ft.
 - Salon: 6,000 sq. ft.
- Ceiling Height: 28 feet
- 23 Meeting Rooms, Unlimited Load Bearing Floor, Nine Loading Docks, Full-Service Kitchen

ARENA AT GWINNETT CENTER

- Square-footage of Facility: 375,000
- Seating Capacity: 13,000
- Dressing Rooms, Concessions

SUWANEE SPORTS ACADEMY

- Square-footage of Complex: 100,000
- Ceiling Height: 25 feet
- Seating Capacity: 5,000
- Concessions, Meeting Rooms, Locker Rooms

GWINNETT COUNTY FAIRGROUNDS

- Square-footage of Facility:
 - Exhibit Hall: 20,000
 - Entertainment Building: 9,600
- Meeting Rooms

NORTH ATLANTA TRADE CENTER

- Square-footage of Facility: 120,000
- Ceiling Height: 24 feet
- Concessions, Locker Room

> Equestrian

CHÂTEAU ÉLAN EQUESTRIAN CENTER

- 150-feet x 250-feet covered Arena
- Four all-weather rings
- 2 warm-up areas
- 196 permanent stalls
- Concessions, On-Site Restaurant, Security

ARENA AT GWINNETT CENTER

- Square Footage: 375,000
- Seating Capacity: 12,000
- 38 Suites
- High-end sound system and acoustic enhancements

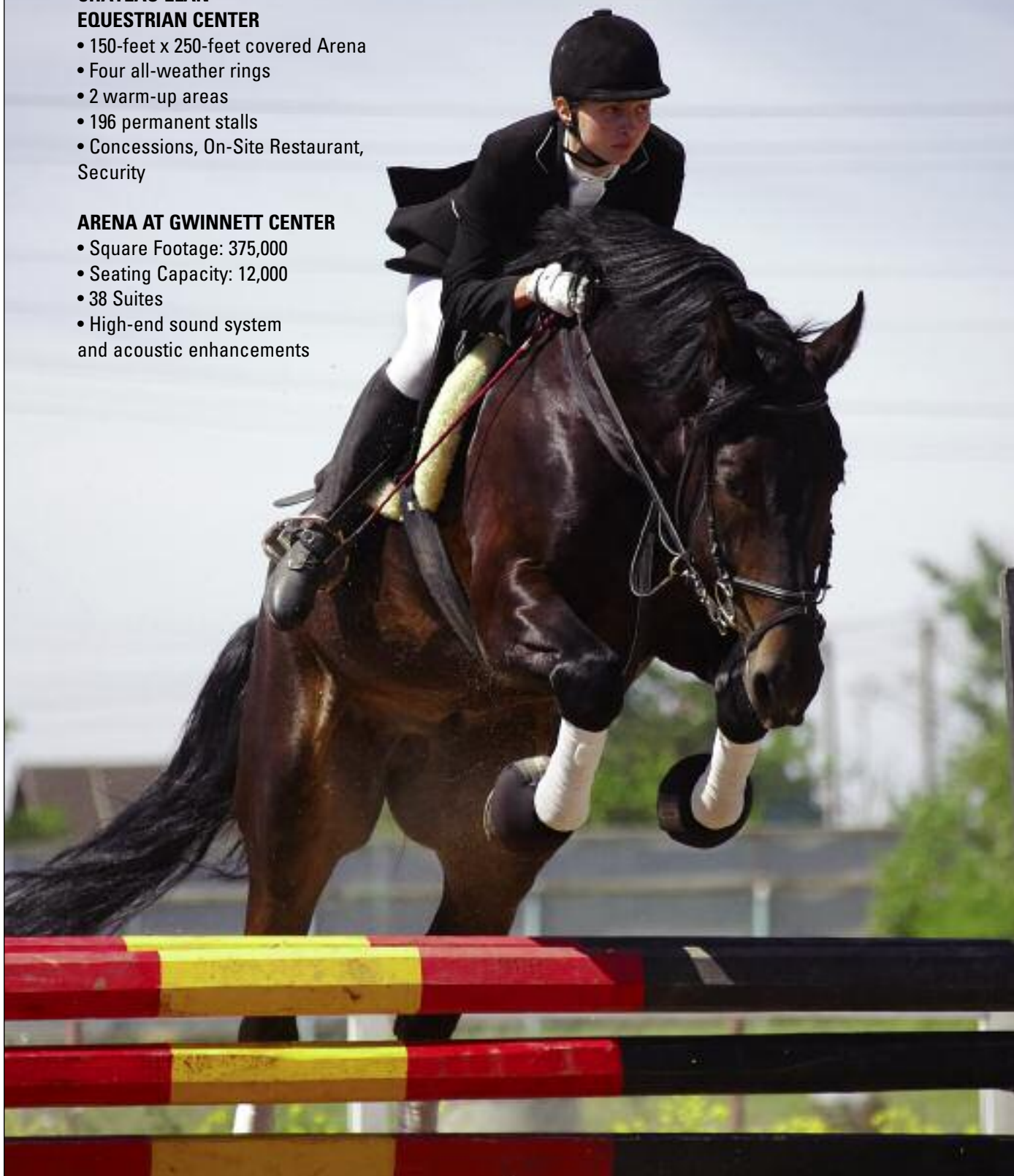

> On Ice



ICE HOCKEY, INLINE HOCKEY, FIGURE/SYNCHRONIZED SKATING

ATLANTA ICE FORUM

- Number of Sheets of Ice: 2
- Ice Surface Size: 200' x 85' (NHL Regulation)
- Full-Service Restaurant, Pro Shop, 8 Locker Rooms, Skate Sharpening

ARENA AT GWINNETT CENTER

- Number of Sheets of Ice: 1
- Ice Surface Size: 200' x 85' (NHL Regulation)
- Seating Capacity: 11,200
- Concessions, Locker Rooms, 4,900 Spaces Free Parking

SGAA IN-LINE HOCKEY COMPLEX

- Number of Rinks: 2 Indoor
- Size of the Rinks: Regulation Size
- Concessions, Locker Rooms, Meeting Rooms

PINCKNEYVILLE PARK

- Number of Rinks: 1 Outdoor
- Size of the Rink: Regulation Size
- Concessions



> Football / Rugby / Lacrosse

BAY CREEK PARK, BUFORD

- Number of Fields: 1
- Size of Field: 120 x 80

BETHESDA PARK, LAWRENCEVILLE

- Number of Fields: 1
- Size of Field: 120 x 80
- Lighted

BOGAN PARK, BUFORD

- Number of Fields: 1
- Size of Field: 120 x 80
- Lighted

CEMETERY FIELD, NORCROSS

- Number of Fields: 1
- Size of Field: 120 x 80
- Lighted

DACULA PARK, DACULA

- Number of Fields: 1
- Size of Field: 120 x 80
- Lighted

DUNCAN CREEK, NORCROSS

- Number of Fields: 1
- Size of Field: 120 x 80

GEORGE PIERCE PARK, SUWANEE

- Number of Fields: 1
- Size of Field: 120 x 80
- Lighted

LENORA PARK, SNELLVILLE

- Number of Fields: 1
- Size of Field: 120 x 80

MOUNTAIN PARK PARK, STONE MOUNTAIN

- Number of Fields: 1
- Size of Field: 120 x 80
- Lighted

PEACHTREE RIDGE, DULUTH

- Number of Fields: 1
- Size of Field: 120 x 80
- Lighted

RHODES JORDAN, LAWRENCEVILLE

- Number of Fields: 1
- Size of Field: 120 x 80

ROCK SPRINGS PARK, DACULA

- Number of Fields: 1
- Size of Field: 120 x 80
- Lighted

SHORTY HOWELL PARK, DULUTH

- Number of Fields: 1
- Size of Field: 120 x 80
- Lighted

SOUTH GWINNETT, SNELLVILLE

- Number of Fields: 1
- Size of Field: 120 x 80
- Lighted



> Golf

**ATLANTA ATHLETIC CLUB (P)**

City: Duluth
Yardage: 6,695
Par: 72
Number of holes: 18

BEAR'S BEST GOLF COURSE (PU)

City: Suwanee
Yardage: 6,900
Par: 72
Number of holes: 18

CEDAR LAKE GOLF COURSE (PU)

City: Loganville
Yardage: 6,450
Par: 72
Number of holes: 18

CELEBRITY GOLF CLUB (SP)

City: Tucker
Yardage: 6,903
Par: 72
Number of holes: 27

COLLINS HILL GOLF CLUB (PU)

City: Lawrenceville
Yardage: 6,532
Par: 71
Number of holes: 18

**CHÂTEAU ÉLAN
WOODLANDS COURSE (SP)**

City: Braselton
Yardage: 6,735
Par: 72
Number of holes: 18

CHÂTEAU ÉLAN GOLF COURSE (SP)

City: Braselton
Yardage: 7,030
Par: 71
Number of holes: 18

COUNTRY CLUB OF GWINNETT (SP)

City: Snellville
Yardage: 6,429
Par: 72
Number of holes: 18

GEORGIA TRAIL (PU)

City: Duluth
Yardage: 2,254
Par: 31
Number of holes: 9

HAMILTON MILL GOLF CLUB (SP)

City: Dacula
Yardage: 6,624
Par: 72
Number of holes: 18

LAUREL SPRINGS GOLF COURSE (P)

City: Suwanee
Yardage: 6,805
Par: 71
Number of holes: 18

NORTHWOOD COUNTRY CLUB (PU)

City: Duluth
Yardage: 6,853
Par: 72
Number of holes: 18

OLDE ATLANTA GOLF CLUB (SP)

City: Duluth
Yardage: 6,358
Par: 72
Number of holes: 18

PEACHTREE FAMILY GOLF CENTER (PU)

City: Duluth
Yardage: 2,604
Par: 54
Number of holes: 18

ST. MARLO COUNTRY CLUB (PU)

City: Duluth
Yardage: 6,620
Par: 72
Number of holes: 18

SUGAR HILL GOLF CLUB (PU)

City: Sugar Hill
Yardage: 6,522
Par: 72
Number of holes: 18

THE HOOCH GOLF CLUB (PU)

City: Duluth
Yardage: 4,101
Par: 61
Number of holes: 18

TPC AT SUGARLOAF (P)

City: Duluth
Yardage: 6,829
Par: 72
Number of holes: 18

TROPHY CLUB OF APALACHEE (SP)

City: Dacula
Yardage: 6,210
Par: 71
Number of holes: 18

(P) Private (SP) Semi-Private (PU) Public

> Soccer / Flag Football



BETHESDA PARK

- Number of fields: 6
- Dimensions: 350 feet x 250 feet
- Outdoor, Lighted, Natural Grass, Concessions

GEORGE PIERCE PARK

- Number of fields: 5
- Dimensions: 180 feet x 100 feet (2 Fields)
250 feet x 175 feet (1 Field)
300 feet x 200 feet (1 Field)
350 feet x 250 feet (1 Field)
- Outdoor, 3 Lighted, Natural Grass, Concessions

GWINNETT SPORTS CENTER

- Number of fields: 1
- Number of fields: 1 (85 feet x 200 feet)
- Indoor, Artificial Turf, Snack Bar

HARMONY GROVE SOCCER COMPLEX

- Number of fields: 5
- Dimensions: 300 feet x 200 feet
- Outdoor, Lighted, Natural Grass, Concessions

JONES BRIDGE PARK

- Number of fields: 4
- Dimensions: 100 feet x 100 feet
- Outdoor, Natural Grass, Concessions

PEACHTREE RIDGE

- Number of fields: 1
- Dimensions: 120 feet x 80 feet
- Outdoor, Natural Grass, Concessions

PINCKNEYVILLE SOCCER COMPLEX

- Number of fields: 5
- Dimensions: 300 feet x 200 feet
- Outdoor, Lighted, Natural Grass, Concessions

RABBIT HILL PARK

- Number of fields: 5 Youth Fields
1 Adult Field
- Dimensions: 350 feet x 200 feet
- Outdoor, Natural Grass, Concessions

> Tennis



BAY CREEK PARK

- Number of Courts: 4 Lighted
- Playing Surface: Hard Court

BEST FRIEND PARK

- Number of Courts: 16 Outdoor Lighted
- Playing Surface: Hard Court
- Concessions

COLLINS HILL ATHLETIC CLUB

- Number of Courts: 4 Clay-Hydro Lighted
- Playing Surface: 12 Har-Tru Lighted
- Full-Service Restaurant, Locker Rooms, Fitness Center

DACULA PARK

- Number of Courts: 4 Outdoor Lighted
- Playing Surface: Hard Court

GRAVES PARK

- Number of Courts: 2 Outdoor
- Playing Surface: Hard Court

HUDLOW TENNIS CENTER

- Number of Courts: 17 Lighted
- Playing Surface: Hard Court

LUCKY SHOALS PARK

- Number of Courts: 2 Outdoor Lighted
- Playing Surface: Hard Court
- Concessions

MOUNTAIN PARK PARK

- Number of Courts: 6 Outdoor Lighted
- Playing Surface: Concrete
- Concessions

RACQUET CLUB OF THE SOUTH

- Number of Courts: 18 Outdoor Lighted
8 Indoor Lighted
- Playing Surface: 22 Har-Tru
4 Clay
- Center Court Seating Capacity: 3,000
- Full-Service Restaurant, Locker Rooms, Meeting Rooms

RHODES JORDAN PARK

- Number of Courts: 8 Outdoor Lighted
- Playing Surface: Concrete
- Concessions

ROCK SPRINGS PARK

- Number of Courts: 6 Lighted
- Playing Surface: Hard Court

SWEETWATER PARK

- Number of Courts: 2 Outdoor
- Playing Surface: Hard Court

> Volleyball

SUWANEE SPORTS ACADEMY

- Square-footage of Complex: 100,000
- Number of Courts: 9
- Size of Volleyball Boundaries: USA Volleyball Regulation
- Floor Type: Wood
- Seating Capacity: 5,000
- Concessions, Meeting Rooms, Locker Rooms, Press Area, PA System

ARENA AT GWINNETT CENTER

- Square-footage of Facility: 375,000
- Number of Courts: 1
- Size of Volleyball Boundaries: USA Volleyball Regulation
- Floor Type: Wood
- Seating Capacity: 13,000
- Concessions, Locker Rooms, Press Area, PA System

OUTDOOR SAND VOLLEYBALL

- Bogan Park, Buford (4 courts)
- Collins Hill Park, Lawrenceville (1 court)
- Dacula Park, Dacula (1 court)
- Duncan Creek Park, Dacula (3 courts)
- Graves Park, Norcross (1 court)
- Jones Bridge Park, Norcross (1 court)
- Sweetwater, Lawrenceville (1 court)

